



THE HENSON SOUNDSTAGE

1416 NORTH LA BREA AVE.
 HOLLYWOOD, CA 90028
 323.802.1500

- BATHROOMS
- SHOWER
- LOADING DOCK
- WALL POWER
- DUAL CURTAIN TRACK
- NOT AVAILABLE FOR RENTAL



FOR BOOKING INQUIRIES:
HOWARD SHARP
 STAGE MANAGER
 323.856.2682
 HSHARP@HENSON.COM

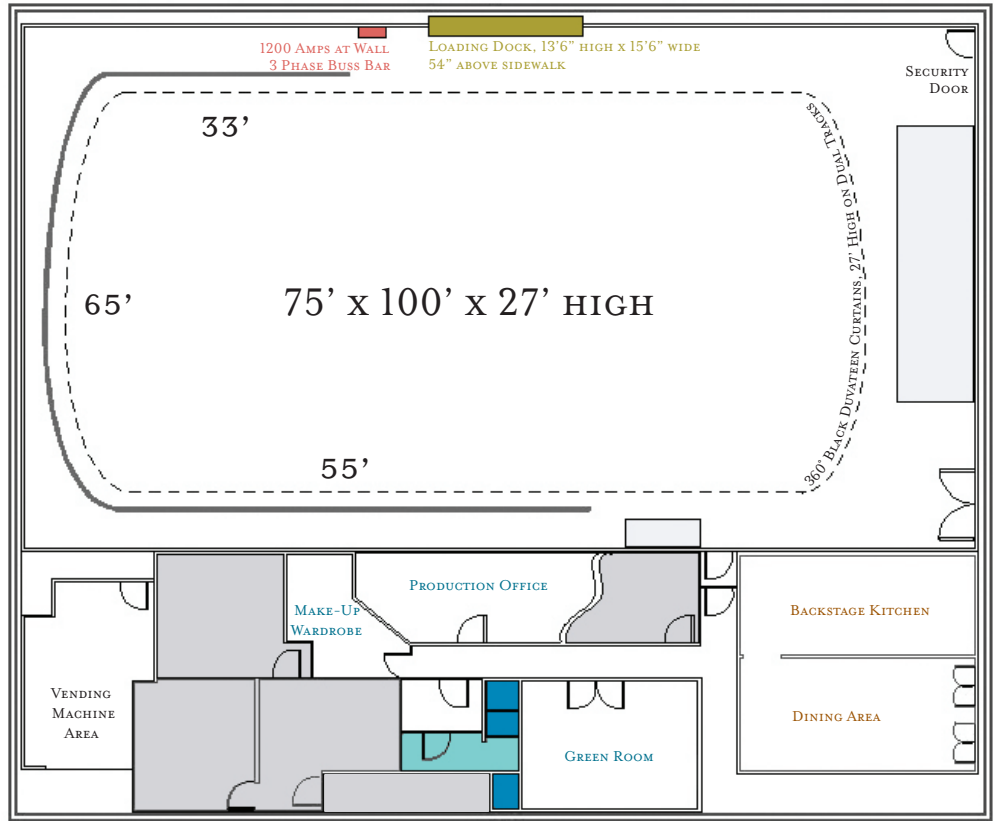

BASIC SPECIFICATIONS	AIR CONDITIONED STAGE, CONCRETE FLOOR, 54" HIGH LOADING DOCK, DOOR OPENING 13'6" X 15'6"
CYC	180° PERMANENT HARDWALL 55' X 65' X 33' X 25' HIGH, 360° BLACK DUVATEEN CURTAINS 27' HIGH ON DUAL TRACK
POWER	1/1200 AMP HOOK UP (3 PHASE BUSS BAR) AT WALL, ALSO 1200 AMPS AVAILABLE IN LOWERING GRID
LIGHTING / GRIP	90 INDEPENDENT COUNTERWEIGHTED ARBOR PIPES (42 ELECTRIC 60 AMP BATES, 48 CARPENTER) HIGH TRIM 26', LOW TRIM 3'
TELEPHONES	1 STAGE LINE, 2 PRODUCTION LINES

PRE-LIGHT / SHOOT	\$1,450 / 12-HOUR DAY
PREP / STRIKE	\$1,050 / 12-HOUR DAY
STILL SHOOT	\$1,050 / 12-HOUR DAY (INCLUDES POWER)
OVERTIME	\$100 / HOUR
POWER	PRE-LIGHT/SHOOT: \$50 / HOUR PREP/STRIKE: \$125 / DAY
AIR CONDITIONING	\$250 / DAY
STAGE MANAGER	WEEKDAYS: INCLUDED IN RENTAL RATES. WEEKENDS: \$35 / HOUR
DRESSING / SUPPORT ROOMS	\$50 / DAY; \$200 / WEEK
TELEPHONES/FAX/INTERNET	\$50 / DAY (ALL INCLUSIVE)
PHOTOCOPIERS	B/W COPYMACHINES AVAILABLE ONSITE, \$0.05 / PER PAGE
SECURITY (REQUIRED)	\$25 / HOUR; \$35 / HOUR – OVERTIME RATE. PRODUCTION MAY ALSO BRING IN THEIR OWN SECURITY SERVICES
PARKING	(5) SPACES ON REAR LOT INCLUDED. ADDITIONAL PARKING \$7.00 PER SPACE WHEN AVAILABLE

* ALL PRICES SUBJECT TO CHANGE.